



# PACKTALK EDGE

GREATNESS. REBORN.

## Greetings from Cardo!

Thank you for your time and interest in Cardo Systems. We have prepared a Review Guide to make sure you don't miss any of the new and improved features of the PACKTALK Edge. Can't wait for you to experience Greatness. Reborn.

**PACKTALK EDGE** is the most advanced communication system in the world. Powered by the 2nd generation of Cardo's Dynamic Mesh Communication, PACKTALK EDGE provides an unprecedented crystal clear sound and an easy, lightning-fast pairing for a group of up to 15 riders, at a range of up to 1.6km/1mi. Among its many improved features are upgraded Natural Voice engine, enhanced JBL Sound, and improved noise-canceling microphone, for an exceptional on-the-road sound and communication experience. Fast Charging and over-the-air software updates complete the list of features and improve significantly the ease of use. Waterproof, PACKTALK EDGE comes in a slim modern design with no external antenna, a USB Type-C port, and a revolutionary and secure magnetic Air Mount. Universal fit, unrivaled performance, the leader of the Pack is better than ever.

## ABOUT cardo

Cardo Systems specialises in the design, development, manufacturing and sale of state-of-the-art communication and entertainment systems for motorcycle helmets. Since inception in 2004, Cardo has pioneered the vast majority of innovations for Bluetooth motorcycle communication systems. The company's products, now available in over 100 countries, are the world's leading communication devices for the motorcycle industry.



# PACKTALK EDGE

GREATNESS. REBORN.

Universal Fit. Unrivalled Performance.

**3 YEAR**  
WARRANTY

Receive a 3 year warranty for extended coverage.



**AIR MOUNT**

Just bring your PACKTALK EDGE near the magnetic mount and it will snap on. Simple, Easy and Secure.



**DYNAMIC MESH**  
COMMUNICATION

Featuring our 2nd generation Dynamic Mesh Communication (DMC) with unparalleled intercom sound quality, easy pairing, and robust performance. For up to 15 riders at a range of 1.6km/1mi.

SOUND BY **JBL**

Powerful 40mm high-definition speakers engineered to perfection by JBL experts, with an improved music processor and three redesigned audio profiles.



OPERATED BY **NATURAL VOICE**

Our improved Natural Voice Operation engine rids you from the need to ever press a button again. Just say "hey Cardo" and tell it what you want, your PACKTALK EDGE will do the rest.

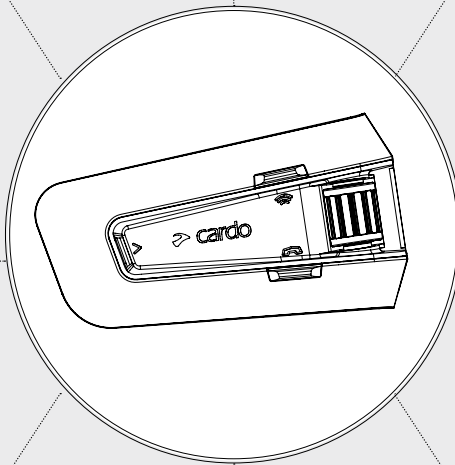

**OVER THE AIR SOFTWARE UPDATES**

Keeping your unit up-to-date has never been so easy. Use your Cardo Connect App to download and install latest software directly to your PACKTALK EDGE. No cables needed.



**WATERPROOF**

No matter what you throw at it, your waterproof PACKTALK EDGE will take the beating and keep you connected. Rain, shine, mud, dust or snow.



**UNIVERSAL BLUETOOTH CONNECTIVITY**

PACKTALK EDGE connects with any other Bluetooth intercom system of any brand.

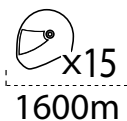



# PACKTALK EDGE

GREATNESS. REBORN.

## How to test the PACKTALK EDGE

### Air Mount

After installing the cradle on your helmet, just snap the system on it. It attaches immediately, and once it is attached it won't go. To detach the unit, press the button and the unit will slide out of the cradle.

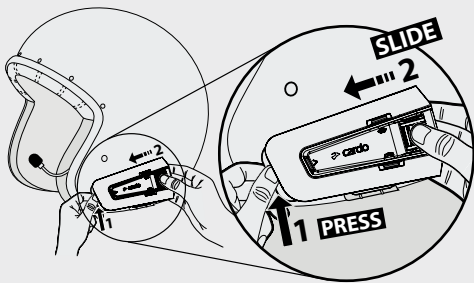

### Intercom Audio Quality

Experience crystal clear wideband intercom voice. Also test it in a situation of wind or with the boom microphone on a jet helmet, to appreciate the noise filtering capability of the microphone.

### Natural Voice Operation

Just say "Hey Cardo" and give your instructions. PACKTALK EDGE will do the rest.

"Hey Cardo, Music on"

"Hey Cardo, next track"

"Hey Cardo, volume up"

A list of all commands can be found in the Cardo Connect App or on the last pages of the PACKTALK EDGE Pocket Guide.

### Parallel audio streaming and Music sharing

Listen to music in parallel with intercom. In addition, the personal music source can also be shared with a pillion, the activation of this option is easy via the Cardo Connect app.

### Sound by JBL Profiles and Audio Quality

Open Cardo Connect App, and switch between the audio profiles: Bass Boost, Vocal, High Volume (the latter is especially of use while constantly riding with higher speeds and/or with earplugs to counter the wind noise of the helmet).

### Fast Charging

To experience fast charging, first drain your battery, then connect your unit with the USB-C cable to any power socket. After 20 minutes, you will have 2 hours of talk time available. Charging – e.g., with a power bank – is also possible while riding.

### Over-the-air Software Update

After pairing your Mobile phone with your PACKTALK EDGE, download Cardo Connect App and follow the on-screen instructions to update the Software.



### Easy and Fast Pairing

Press only one button to pair any PACKTALK to the DMC group. No administrator is needed, any rider can join the group by pressing the intercom button. The pairing is lightning fast. Optionally, the Cardo Connect app can also be used to define "private chat" partners - for example, the pillion passenger - for communication outside the group

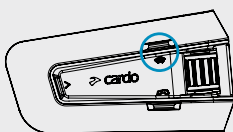



# PACKTALK EDGE

## GREATNESS. REBORN.

### Specs.

#### General

##### Compatibility

Universal

##### Operating Temperature

-20°C to 55°C / -4°F to 131°F

##### Waterproof

##### FM Radio

Operating frequencies 76-108 MHz

RDS - Radio Data systems

6 preset station memory

##### Software Updates

Over-the-air updates

USB cable updates

##### Device Settings

Cardo Connect App

#### Dimensions

##### Main unit

Height: 46mm | Length: 84mm

Depth: 23mm | Weight: 47g

##### Speakers

Diameter: 40mm

Depth: 10mm

#### Connectivity

2 channels for mobile phone and GPS

2nd gen Dynamic Mesh Communication

Bluetooth 5.2

Universal connectivity

TFT connectivity

#### Intercom

2nd gen DMC intercom

Auto-reconnect, HD Live

Bluetooth Intercom

Universal Bluetooth intercom

Group size : up to 15 riders

Rider to rider range: up to 1.6km / 1 mi

DMC group range : up to 8km / 5.0 mi

#### User interface

Natural Voice operation

Multilingual status announcements

#### Audio

Sound by JBL

40mm JBL speakers

JBL Audio profiles

Automatic Volume Control

#### Battery

##### Talk time

13 hours

##### Charging time

up to 2 hours

##### Fast charging

2 hours talk time after 20 min charge

##### Standby time

10 days

#### Certificates

CE

FCC / IC

SIG BT

TELEC

UKCA

	SPIRIT	SPIRIT HD	FRECOM 2x	FRECOM 4x	PACKTALK SLIM	PACKTALK BOLD	PACKTALK EDGE
Riders	1-2 riders	1-2 riders	1-2 riders	1-4 riders	1-15 riders	1-15 riders	1-15 riders
Range (km/mi)	400m / 0.25mi	600m / 0.4mi	800m / 0.5mi	1.2km / 3/4mi	1.2 km / 0.75 mi	1.6km / 1mi	1.6km / 1mi
FM radio		●	●	●	●	●	●
Speakers	32mm	40mm HD	40mm JBL	40mm JBL	40mm JBL	40mm JBL	40mm JBL
Control wheel			●	●		●	●
Intercom	Regular Bluetooth	HD Bluetooth	Live Bluetooth intercom	Live Bluetooth intercom	DMC	DMC	2nd gen DMC
Natural Voice Operation				●	●	●	●

### AVAILABLE ACCESSORIES



PACKTALK Edge  
2nd Helmet Kit JBL



PACKTALK Edge  
Half Helmet Kit



JBL 45mm Audio Set



# PACKTALK EDGE

## GREATNESS. REBORN.

### Q&A

#### **What are the 3/5 key features that PACKTALK EDGE can do better than the previous PACKTALK units?**

PACKTALK EDGE offers several improved key features, including:

- Air Mount: a completely revolutionary, simple, and secure magnetic mount.
- DMC 2nd generation: lightning-fast pairing and a crystal clear wideband intercom voice.
- A complete redesigned sound system by JBL.
- An improved natural voice operation with an improved noise-filtering microphone.

PACKTALK EDGE also features improvements recently introduced in Cardo portfolio:

- Fast charging: 2 hours of talk time after 20 minutes of charge.
- Over-the-air software updated via the Cardo Connect app.

#### **How did we improve the DMC? How does DMC 2nd generation improve on its 1st generation?**

We have completely rebuilt the DMC protocol from the ground up, and achieved significant improvements with:

- Easier and faster pairing process: The pairing is rapid, lightning-fast, pairing a group of 10 communicators takes no more than a few seconds. We've also simplified the process itself by removing the group admin function. With DMC gen 2 pairing has never been so easy and so fast.
- Wideband intercom: DMC gen 2 provides a crystal clear wideband intercom voice second to none. Expect sound quality akin to a good video conference.

#### **Do the new PACKTALK EDGE models work equally well with the Packtalk Bold generation?**

PACKTALK EDGE is fully compatible with all DMC products. To enjoy the full impact of DMC gen 2, however (quick and simplified pairing and full wide-band sound) you will need the group to all have PACKTALK EDGE.

#### **Is it possible to include another Bluetooth system in a Dynamic Mesh group?**

Yes, any Bluetooth communication system from any brand can be bridged into a Mesh group. Integration of a Bluetooth system is easily done via Cardo Connect App. Bridge range is short. For a full integration of multiple Bluetooth communicators over long ranges, PACKTALK EDGE can be switched into Bluetooth mode and act as any other top-end Bluetooth intercom.

#### **How did we improve Natural Voice Operation in PACKTALK Edge?**

We implemented a new generation of the voice recognition engine in the 8 languages that we cover. On top of it, we improved the noise filtering capability of the microphone, which also significantly improved the efficiency of the natural voice operation.

#### **How did we improve Bluetooth intercom performance?**

We integrated into PACKTALK EDGE our recent improvements in Bluetooth capabilities:

- A Live Intercom Connection with FRCx including auto-reconnection and wide-band sound.
- Complete legacy support to Bluetooth intercom of any brand.
- Rapid, fast, Bluetooth intercom pairing.

#### **How did we improve the sound experience in PACKTALK Edge?**

PACKTALK Edge comes with a completely redesigned sound system by JBL. It is better, stronger, and louder, with 3 newly designed sound profiles, new hardware new software, new technology. In addition, it comes with a wideband Intercom, and a higher phone quality transmission, combined with an all new noise-reducing microphone.





# PACKTALK EDGE

GREATNESS. REBORN.

## Q&A

### Will the Bold/Black/Slim be discontinued?

The PACKTALK BOLD and SLIM will continue to be offered as part of Cardo portfolio. PACKTALK BLACK will be discontinued.

### What technical innovations has the Edge benefited from?

PACKTALK EDGE is full of innovations: the magnetic Air Mount, the 2nd gen DMC, the new Natural voice operation, the filtering noise microphone, the over-the-air software updates via Cardo Connect App with no cables, fast charging, and more. PACKTALK EDGE innovations are based on the most advanced Bluetooth 5.2 chip in the market.

### How have the controls been improved for ease of use? What research has been done?

Cardo conducted in-depth Market research with it's international user-base, and came up with significant design improvements as follows:

- Buttons are now much larger for easier operation with gloves
- Improved voice operation engine.
- Features UI remapping to enable easy and fast activation of the most frequent applications.
- More advanced features have been moved to the app.

### Why did you get rid of the antenna? Does this impact range?

We did this for the looks, aerodynamics, and reliability.

Maintaining the range performance without a pop-up antenna was a big challenge, but with the use of the complete new and energy-efficient chipset, we were able to achieve the same range without an antenna.

### How do the sound profiles differ from the Bold?

PACKTALK EDGE comes with 3 newly designed sound profiles:

- "Bass Boost" which provides more bass.
- "Vocal" which provides a clearer sound
- "High Volume" provides a much louder sound than ever before.

### How easily are the over-the-air updates completed?

Just open the Cardo Connect app and an available update will pop-up automatically.

Updating a communication system has never been so easy.

### Why does Cardo have a limit of 15 people in a mesh group when other headsets in the market that can be larger?

Our 7 years of experience with PACKTALK, and the feedback that we collected from riders all around the world, led to the conclusion that the requirement for groups larger than 15 riders is marginal, at best. The main requirement was for a better sound experience and ease of operation. That is the reason why we concentrated the capabilities and performance of our award winning DMC, rather than than total limit to the number of riders.

## cardo CONNECT APP



The Cardo Connect App provides complete control over Cardo's range of products. With a smooth user experience and clean, modern design. Cardo Connect has everything you need to set, pair, control, upgrade and update your Cardo unit. Cardo Connect is available for download, free of charge, in an App Store near you.

